

CURVA COMPATTA A 90° CON DADO SPINATO - CONO JIC 74° - ISO 8434-2 (SAE J514)

Filetto UNF/UN-2B

90° COMPACT ELBOW THURST-WIRE - JIC 74° CONE - ISO 8434-2 (SAE J514)

UNF/UN-2B thread

Codice/Code: 7021..
 Tipo/Type: DKJ90-K

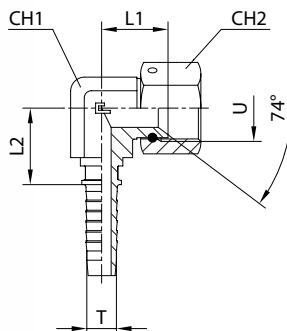

CODICE Code	Ø interno tubo T I.D. hose			U	L1	L2	CH1	CH2	PN WP [bar]
	DN	size	INCH						
702101	5	-3	3/16	7/16-20	17	16,5	11	14	415
702102	6	-4	1/4	1/2-20	17	18,5	14	17	450
702103	8	-5	5/16	9/16-18	22	22,5	19	19	350
702104	10	-6	3/8	3/4-16	24	23	19	22	350
702105	12	-8	1/2	7/8-14	28	26	22	27	350
702106	16	-10	5/8	1 1/16-12	30	29	27	32	350
702107	19	-12	3/4	1 3/16-12	34,5	34,5	33	36	290
702108	25	-16	1	1 5/16-12	35	40,5	33	41	290

CURVA A 45° CON DADO GRAFFATO - CONO JIC 74° - ISO 8434-2 (SAE J514)

Filetto UNF/UN-2B

45° ELBOW CRIMPED-BACK NUT - JIC 74° CONE - ISO 8434-2 (SAE J514)

UNF/UN-2B thread

Codice/Code: 7022..
 Tipo/Type: DKJ45

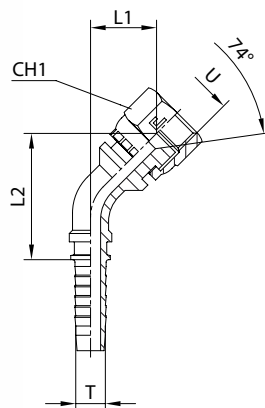

CODICE Code	Ø interno tubo T I.D. hose			U	L1	L2	CH1	PN WP [bar]
	DN	size	INCH					
702201	5	-3	3/16	7/16-20	13,5	38,5	14	415
702202	5	-3	3/16	1/2-20	13,5	38,5	17	415
702203	6	-4	1/4	7/16-20	13,5	38,5	14	450
702204	6	-4	1/4	1/2-20	13,5	38,5	17	450
702205	6	-4	1/4	9/16-18	14	39	19	350
702206	8	-5	5/16	9/16-18	16,5	46,5	19	350
702207	10	-6	3/8	9/16-18	18,5	52,5	19	350
702208	10	-6	3/8	3/4-16	20,5	55	24	350
702209	10	-6	3/8	7/8-14	21,5	56	27	350
702210	12	-8	1/2	3/4-16	20,5	63	24	350
702211	12	-8	1/2	7/8-14	21	63,5	27	350
702212	12	-8	1/2	1 1/16-12	24	67	32	350
702213	16	-10	5/8	7/8-14	21,5	70	27	350
702214	16	-10	5/8	1 1/16-12	25	73	32	350
702215	19	-12	3/4	1 1/16-12	28	84,5	32	350
702216	19	-12	3/4	1 3/16-12	31	87,5	36	290
702217	19	-12	3/4	1 5/16-12	31,5	88	41	290
702218	25	-16	1	1 5/16-12	30	107,5	41	280

NOTE: Desiderando ordinare il raccordo in acciaio inox, sostituire nel codice il 70.. iniziale con 71..

NOTE: If you wish to order a fitting in stainless steel, please change the first two digit from 70.. to 71..